

300-LEVEL

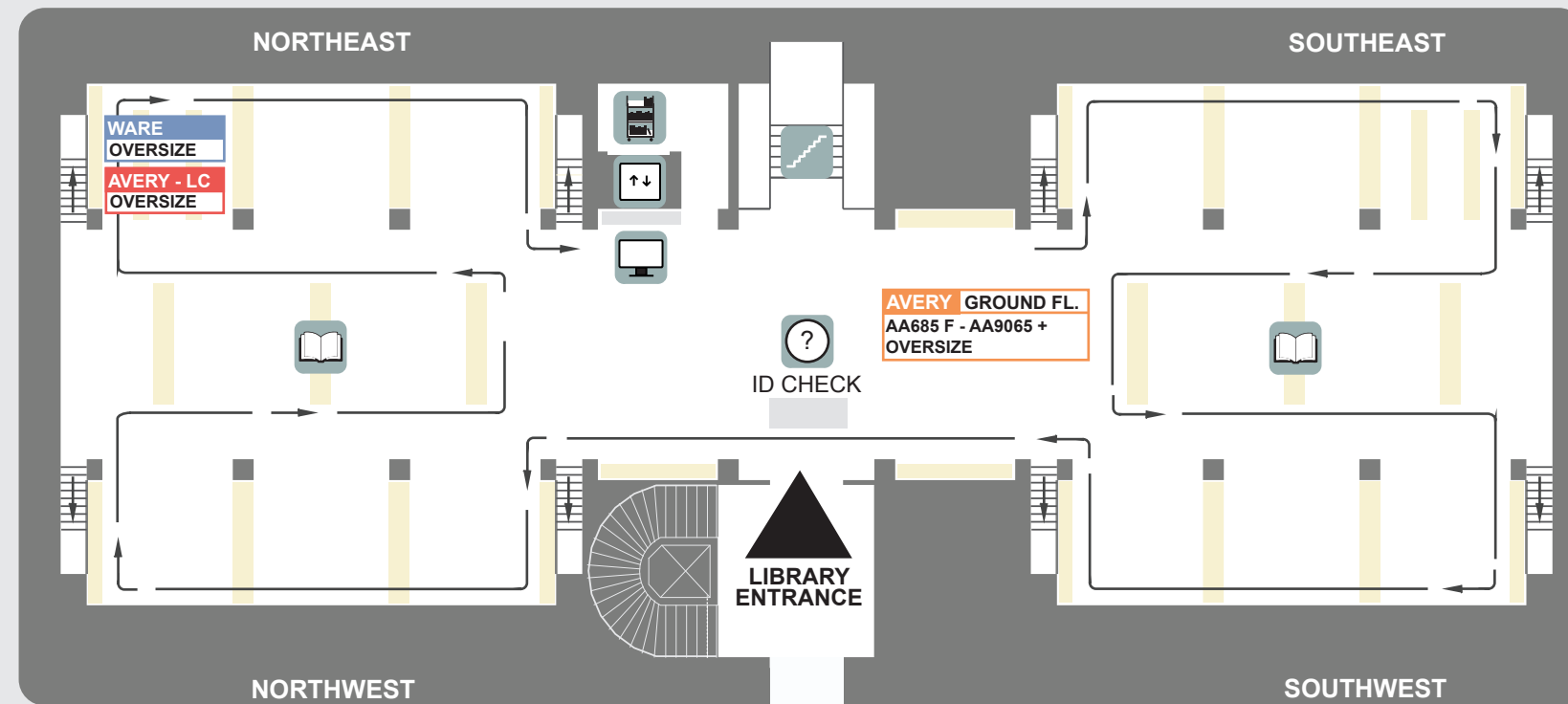

KEY:

-  In-Person Help
-  Computer Stations
-  Print Stations
-  Scanning Stations
-  Women's Restrooms
-  Stairs to the next level
-  Men's Restrooms
-  Elevators
-  Reading Area
-  By Appointment
-  Reshelfing Area
-  Water Fountain
-  Book Stacks
-  Study Carrels

CALL NUMBER LOCATION GUIDE

WARE OVERSIZE	A - N6879 N6880 - N9999 NA - Z Folios [F] Double Folios [FF]	200-level, section A 200-level, section B 200-level, section C 300-level 200-level
AVERY - LC OVERSIZE		
AVERY	AA11 - AA9065 AA9066 - AZ Folios [F] Double Folios [FF] Triple Folios [FFF]	300-level 200-level, Rm 221 300-level 200-level 200-level
FINE ARTS	N10 - N7410 N7411 - NK Quartos [Q] Folios [F]	200-level, Rm 221 200-level 100-level 200-level
WARE	A - Z Folios [F]	200-level, Rm 221 300-level
PERIODICALS	Current Bound	200-level, Rm. 222 100-level

AVERY SPECIAL COLLECTIONS

Avery Library oversees three special collections; materials in special collections are available for use by appointment.

- CLASSICS (Rare Books)**
 Avery Classics: architectural rare books from the Renaissance to today, trade catalogs, ephemera collections and pre-2011 Columbia GSAPP masters' theses
 Avery Classics Reading Room, 234
avery-classics@library.columbia.edu
- DRAWINGS AND ARCHIVES**
 Avery Drawings & Archives: architectural drawings and papers of primarily American architects of the 19th - 20th centuries
 Wallach Study Center for Art & Architecture
avery-drawings@library.columbia.edu
- ART PROPERTIES**
 Art Properties: the art collection of Columbia University in all media from all world regions and cultures
 Wallach Study Center for Art & Architecture
artproperties@library.columbia.edu

STAFF OFFICES

Rm 213A	Drawings + Archives Curator
Rm 221A	Access + Reserves Staff
Rm 223	Architecture Librarian
Rm 224	Fine Arts Librarian
Rm 225	Librarian
Rm 226	Librarian
Rm 227	Art Properties Curator
Rm 228	Registrar + Digital Content Librarian
Rm 229	Head of Access Services
Rm 230	Avery Director
Rm 233	Classics (Rare Book) Curator

300 MEZZANINE-LEVEL

